

Work manual

— M-1602D-A01C —



Brief introduction

Touch Panel

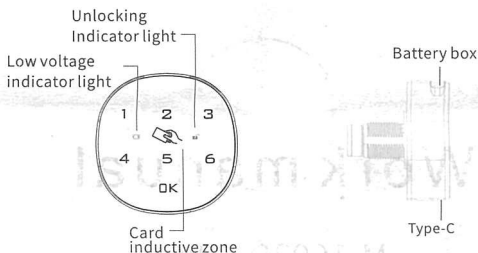

Technical parameters

Management password	4321	Management card	1
User password	1234	User card	10
Working temperature	-20 ~ +55°C	Static current	<40uA
Working humidity	10% ~ 85% RH	Dynamic current	<100mA
Storage temperature	-40 ~ +55°C	Batteries life time	About 1 year
Power supply	CR2450		

How to operate

1. Factory default user code 1234, factory default management code 4321. Card database is empty, card can not unlock before added.
2. With private mode and public mode, factory default mode is private mode.

Lock & unlock

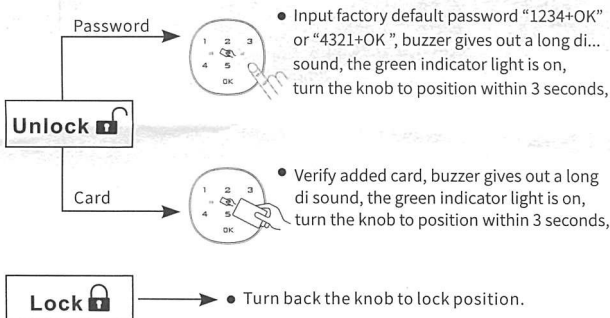

*** NOTE:**

- When password is wrong alarming sound di..di..di.. 3 times;
- When unlock, the red indicator light is on means low voltage;
- When using the management password unlock succeed, user password will be changed back to original password: 1234.

Setting password

► Change management password

- 1> Input current management password "4321+OK", press OK at least 2s until the green indicator light flash,
- 2> Input new management password "*****+OK", when you heard a long di... sound means management password already been changed.

*** NOTE:**

- Password can be consisted of 4~15 digits

► Change user password

- 1> Input current user password "1234+OK", press OK at least 2s until the green indicator light flash,
- 2> Input new user password, *****+OK, when you heard a long-di sound means user password already been changed.

*** NOTE:**



- Password can be consisted of 4~15 digits, pls note that the management password can not be the same as user password

Setting card

► How to add management card

- 1> Input current management password, press "OK", press OK at least 2s until the green indicator light flash,
- 2> Use card to close to inductive zone , buzzer gives out a long di... sound, addition succeeds, this new card will be management card, you can continue to add other card as management card (1 at most)

► How to add user card

- 1> Use management card 1 time , you will hear a long di... sound and see the green indicator light is on
- 2> Use management card again , the green indicator light will flash
- 3> Take any other card to be added , when you heard a long di... sound, this new card will be user card, you can continue to add the other user card (10 at most)

*** NOTES:**

- Management card is with unlocking and deleting user card function, management card and user card can not be the same card

► **How to delete single user card**

- 1> Use management card 3 times, you will hear a long di... sound and see the red indicator light will flash,
- 2> Use user card you want to delete, heard a long di... sound, deleted successfully, you can continue to delete the other user card (management card cannot be deleted).

► **How to delete all cards**

Use management card 5 times, you will hear 2 long di di sound, all cards are deleted successfully.

How to switch the mode

► **Turn on public mode, set temporary password/card**

► **Turn on public mode**

- 1>Input management password+OK, buzzer gives out a long di... sound, the green indicator light is on
- 2>Press OK at least 2s, the green indicator light flash, press OK again,
- 3>Input "4 4+ OK", when you heard a long di... sound means public mode already been turned on

► **Set temporary password**

- 1>Press OK, input the new password consisted of 4-15 digits
- 2>Press OK, when you heard a long di... sound, the green indicator light is on, temporary password already been set

► **Set temporary card**

- 1>Verify any card
- 2>When you heard a long di... sound, the green indicator light is on, temporary card already been set

*** NOTE:**

- After converting to the public mode, clear the previously added cards. In the public mode, you need to add the management card again. Only one management card can be added and user cards cannot be added
- After the temporary password/temporary card is successfully set, the green light flashes every 3s. (Power off and then on again, the password/card still exists, and the green light still flashes every 3s)
- Temporary password/card can be used for 1 time only
- Under public mode, management code and management card can delete temporary code, pls well keep it

► Turn off public mode

- 1> Input management password+OK, buzzer gives out a long di... sound, the green indicator light is on
- 2> Press OK at least 2s, the green indicator light flash, press OK again,
- 3> Input "4 3+OK", when you heard a long di... sound means public mode already been turned off

Special function description

1> Decode

- ① Lock body code: when password been forgotten, you can get the decode number by providing the code on the lock body to the distributor, the password will get back to factory default "1234" and "4321"; clear code/cards and unlock, do not restore mode (public and private mode).
- ② RST: use the pin to press the reset hole at least 3s, the password will get back to factory default "1234" and "4321"; clear code/cards without unlock, do not restore mode (public and private mode).
- ③ USB-KEY: use TypeC-KEY(need to purchase from an agent), the password will get back to factory default "1234" and "4321"; clear code/cards without unlock, do not restore mode (public and private mode).

- 2> Auto-alarm will be activated when input wrong password 4 times and the lock will be died for 60s.

3> Battery low voltage prompts

When the buzzer give out di di di 3 times, and the red indicator light is on means battery at low voltage, pls place the battery in time, the lock may not work when the voltage is low.

4> Emergency power supply

When the battery is in low voltage condition, you can connect the Type-C port with an external power supply.

- 5> In input mode, long press the OK key to turn off/on the buzzer sound.

Fixing hole size & installation

▼ Fixing hole size Unit: mm

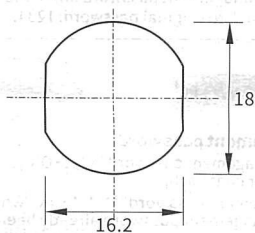

Metal / Wood panel

▼ Installation Unit: mm

Suitable thickness for wooden door: 16~20mm

Suitable thickness for metal door: 0.5-2mm

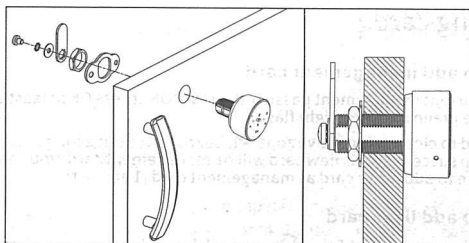

(Wood)